

RevNo	Revision note	Date	Checked
1	RoHS Compliant	041105	PC

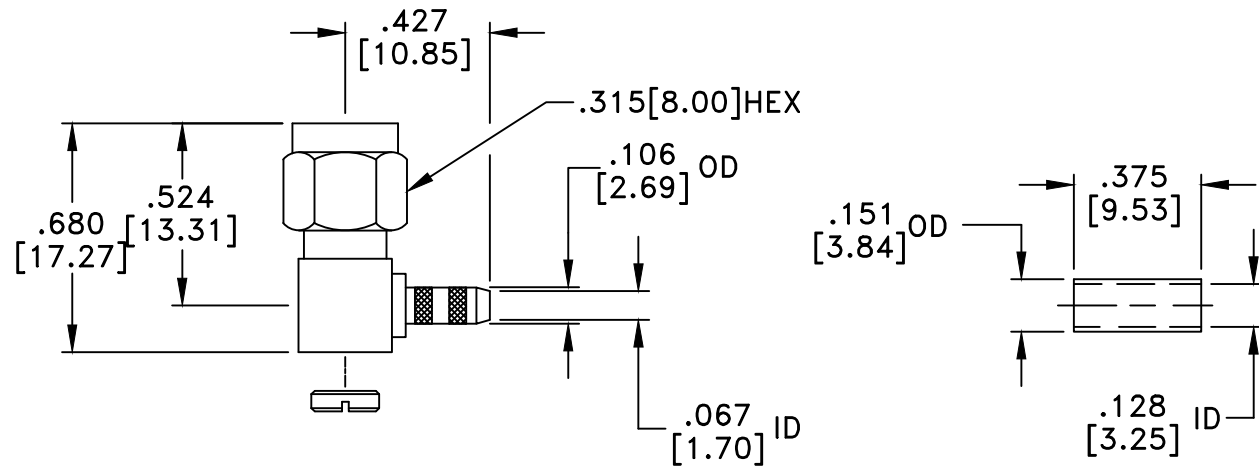
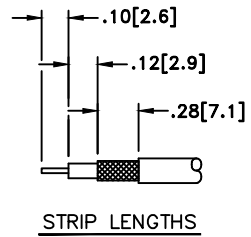

RoHS Compliant

MATERIAL

BODY	BRASS
BODY PLATING	GOLD
PIN	BRASS
PIN PLATING	GOLD
DIELECTRIC	TEFLON (PTFE)

50 Ohm IMPEDANCE
 500V PEAK VOLTAGE RATING
 TEMPERATURE RANGE: -55°C TO +155°C
 INTERFACE DIMENSIONS SIMILAR TO MIL-C-39012

MILLIMETER WAVE TECHNOLOGIES
 6501 W. FRYE ROAD, #23
 CHANDLER, AZ 85226

SMA PLUG R/A CRIMP
 CABLE END RG316

Designed by
 N. JAIN

Checked by
 W CANON

Approved by
 K WILSON

File name
 MWA-8001-G-316

TITLE
 MWA-8001-G-316

TOLERANCES
 DIMENSIONS ARE IN INCHES UNLESS
 OTHERWISE SPECIFIED
 DECIMALS ANGULAR
 .XX ± .02 ± .06
 .XXX ± .005 ± .06
 DO NOT SCALE THIS DRAWING

ALL DIMENSIONS LISTED ON THIS DRAWING ARE LISTED FOR
 REFERENCE PURPOSES ONLY AND ARE SUBJECT TO CHANGE.

REV. 1	Scale NONE
Date 022001	Sheet 1 of 1