

RevNo	Revision Notes	Date	Checked
1	Initial Release	051005	PC
2	Redesign with multiple dimensional changes	033017	PC

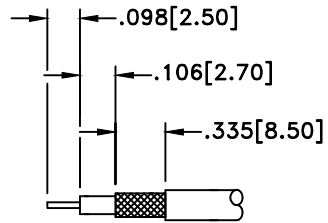

STRIP LENGTHS  
LMR240

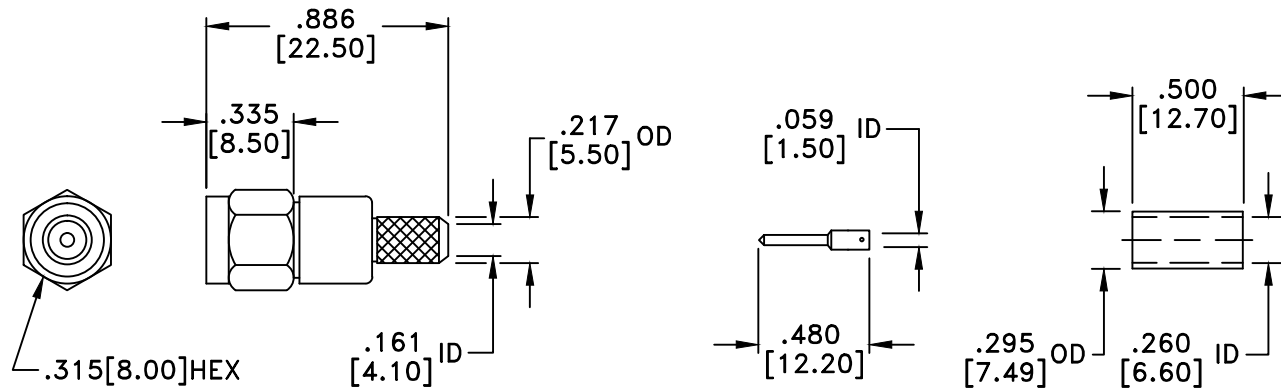

RoHS Compliant

### MATERIALS

BODY	BRASS
BODY PLATING	GOLD
CONTACT	BRASS
CONTACT PLATING	GOLD
DIELECTRIC	TEFLON (PTFE)
FERRULE	BRASS
FERRULE PLATING	GOLD

50 Ohm IMPEDANCE  
500V PEAK VOLTAGE RATING  
TEMPERATURE RANGE: -55°C TO +155°C  
INTERFACE DIMENSIONS SIMILAR TO MIL-C-39012

MILLIMETER WAVE TECHNOLOGIES  
6501 W. FRYE ROAD, #23  
CHANDLER, AZ 85226

SMA MALE CRIMP CABLE END  
w/SEPARATE CONTACT  
for LMR240

Designed by N. JAIN	Checked by W. CANON	Approved by A. LEE	File name MWA-6001-G-L240	TITLE MWA-6001-G-L240	
<b>TOLERANCES</b> <small>DIMENSIONS IN INCHES UNLESS OTHERWISE SPECIFIED</small> DECIMALS .XX ± .02 .XXX ± .005		ALL DIMENSIONS ON THIS DRAWING ARE FOR REFERENCE PURPOSES ONLY AND ARE SUBJECT TO CHANGE.		REV. 2 DATE 051005	Scale NONE Sheet 1 of 1