

RevNo	Revision note	Date	Checked
1	Initial Release	050205	GC

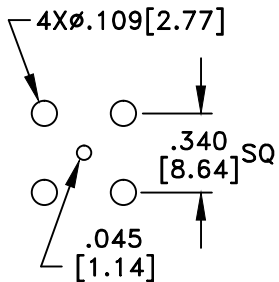

RECOMMENDED
HOLE PATTERN

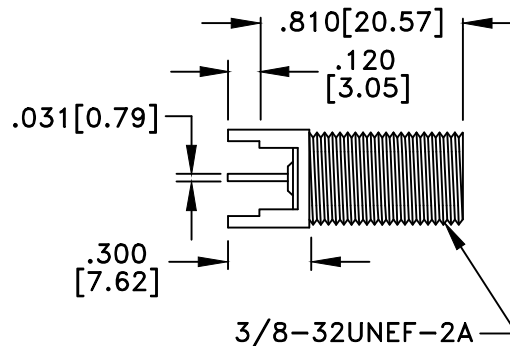
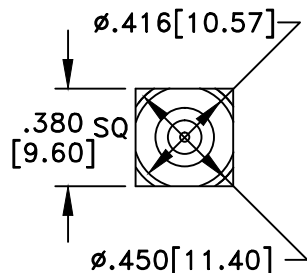

ACCEPTS MALE PIN
ø.020[0.50] - .047[1.19]

MATERIAL

BODY	BRASS
BODY PLATING	NICKEL
PIN	BRASS/BeCu
PIN PLATING	BRIGHT ACID TIN
DIELECTRIC	TEFLON(PTFE)

75 Ohm IMPEDANCE
500V PEAK VOLTAGE RATING
TEMPERATURE RANGE: -55°C TO +155°C
INTERFACE DIMENSIONS SIMILAR TO MIL-C-39012

MILLIMETER WAVE TECHNOLOGIES
6501 W. FRYE ROAD, #23
CHANDLER, AZ 85226

F FEMALE VERTICAL
PCB MOUNT 4 LEGS
HIGH PERFORMANCE

Designed by N. JAIN	Checked by W. CANON	Approved by A. LEE	File name MW-824-75	TITLE MW-824-75
------------------------	------------------------	-----------------------	------------------------	--------------------

TOLERANCES
DIMENSIONS ARE IN INCHES UNLESS
OTHERWISE SPECIFIED
DECIMALS ANGULAR
.XX ± .02 ± .06
.XXX ± .005
DO NOT SCALE THIS DRAWING

ALL DIMENSIONS ON THIS DRAWING ARE FOR REFERENCE
PURPOSES ONLY AND ARE SUBJECT TO CHANGE.

REV. 1	Scale NONE
DATE 050205	Sheet 1 of 1