

RevNo	Revision Notes	Date	Checked
1	Initial Release	02/01/11	PC

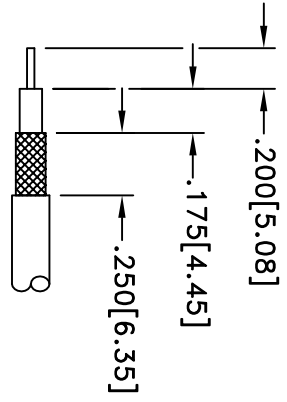

STRIP LENGTHS  
LMR600

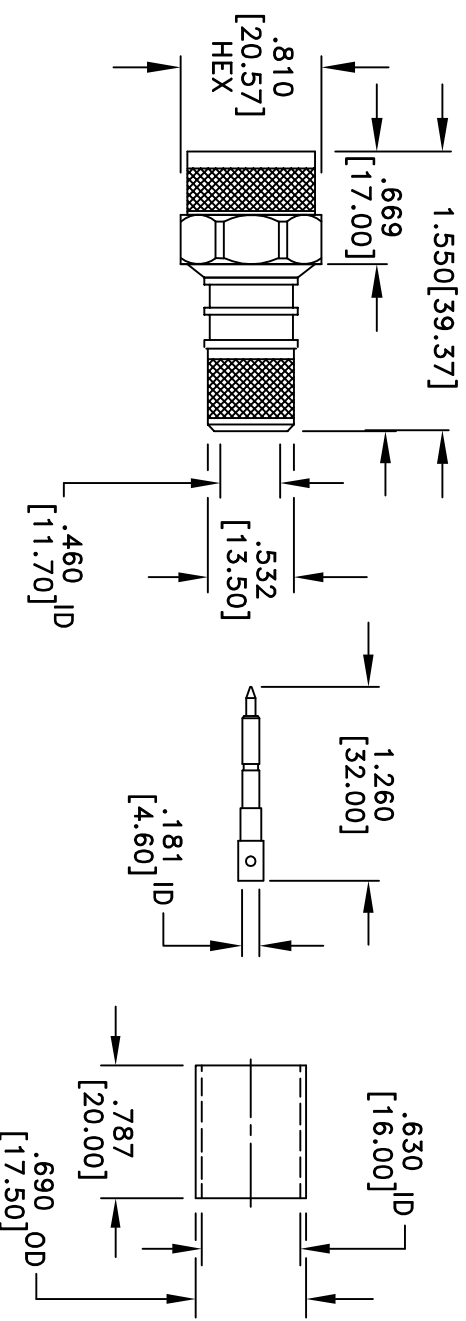

RoHS Compliant

**MATERIALS**

BODY	BRASS
BODY PLATING	NICKEL
CONTACT	BRASS
CONTACT PLATING	GOLD
DIELECTRIC	TEFLON (PTFE)
GASKET	SILICONE

50 Ohm IMPEDANCE  
 500V PEAK VOLTAGE RATING  
 TEMPERATURE RANGE:  $-55^{\circ}\text{C}$  TO  $+155^{\circ}\text{C}$   
 INTERFACE DIMENSIONS SIMILAR TO MIL-C-39012

MILLIMETER WAVE TECHNOLOGIES  
 6501 W. FRYE ROAD, #23  
 CHANDLER, AZ 85226

N PLUG CRIMP CABLE END  
 w/SEPARATE CONTACT  
 for LMR600

Designed by G. COLEEMERE	Checked by S. NEUGESS	Approved by A. LEE	File name MW-350-NT-L600	TITLE MW-350-NT-L600
-----------------------------	--------------------------	-----------------------	-----------------------------	-------------------------

DIMENSIONS IN INCHES UNLESS OTHERWISE SPECIFIED		TOLERANCES	
DECIMALS	$\pm .02$	ANGULAR	$\pm .06$
.XXX	$\pm .005$		
ALL DIMENSIONS ON THIS DRAWING ARE FOR REFERENCE PURPOSES ONLY AND ARE SUBJECT TO CHANGE.			
REV.	1	Scale	NONE
DATE	02/01/11	Sheet	1 of 1