

RevNo	Revision Notes	Date	Checked
1	RoHS Compliant	052105	GC

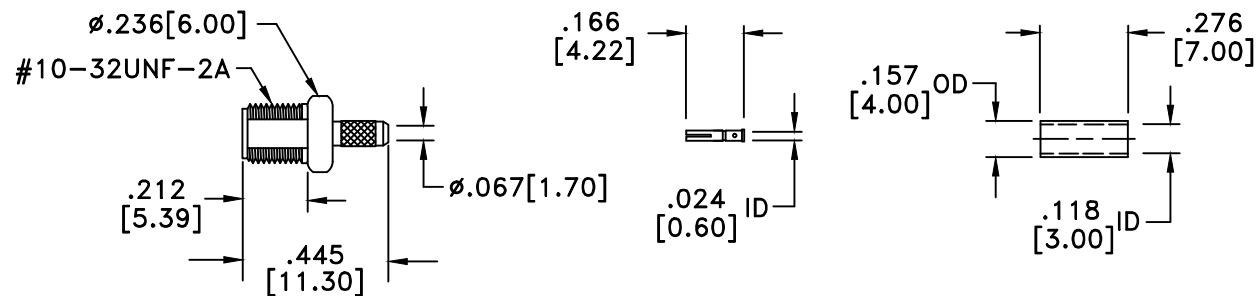

RoHS Compliant

NOTE: INCLUDES LOCKWASHER AND HEX NUT

MATERIALS

BODY	BRASS
BODY PLATING	GOLD
CONTACT	BERYLLIUM COPPER
CONTACT PLATING	GOLD
DIELECTRIC	TEFLON (PTFE)

50 Ohm IMPEDANCE
 500V PEAK VOLTAGE RATING
 TEMPERATURE RANGE: -55°C TO +155°C
 INTERFACE DIMENSIONS SIMILAR TO MIL-C-39012

MILLIMETER WAVE TECHNOLOGIES 6501 W. FRYE ROAD, #23 CHANDLER, AZ 85226			MMCX BULKHEAD JACK CRIMP CABLE END for RG316		
Designed by P. CHEN	Checked by S. NEUGESS	Approved by A. LEE	File name MWXX-6080-G-316	TITLE MWXX-6080-G-316	
TOLERANCES <small>DIMENSIONS IN INCHES UNLESS OTHERWISE SPECIFIED</small> DECIMALS ANGULAR .XX ± .02 ± .06 .XXX ± .005			ALL DIMENSIONS ON THIS DRAWING ARE FOR REFERENCE PURPOSES ONLY AND ARE SUBJECT TO CHANGE.		REV. 1 DATE 010903 Scale NONE Sheet 1 of 1