

RevNo	Revision note	Date	Checked
1	Initial Release	061005	GC
2	Overall design change	072020	GC

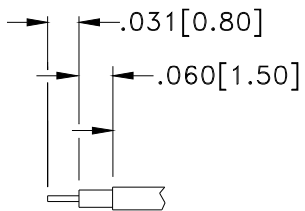

STRIP LENGTHS  
M17/133-RG405

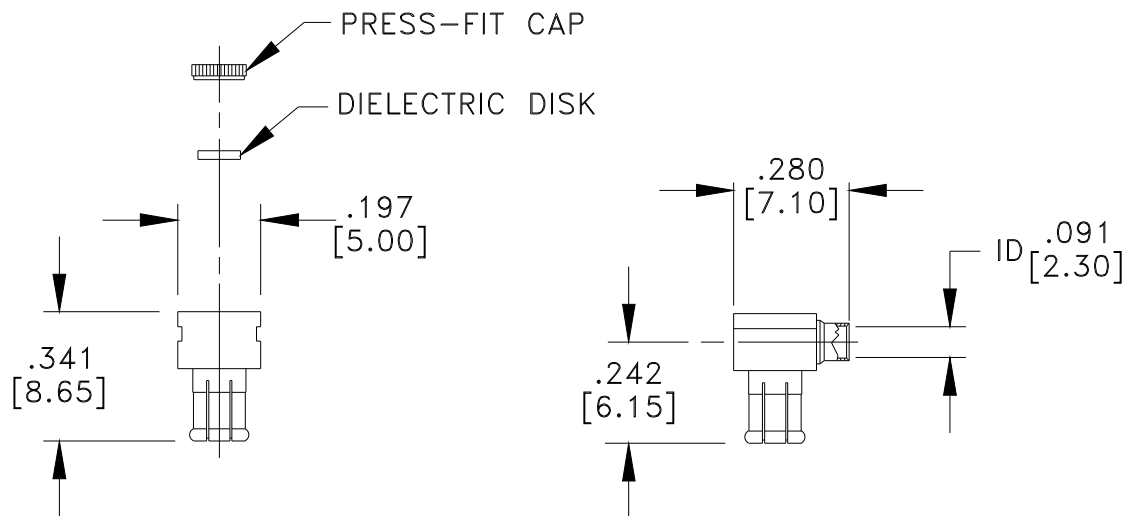

RoHS Compliant

### MATERIAL

BODY	BRASS/BeCu
BODY PLATING	GOLD
CONTACT	BRASS
CONTACT PLATING	GOLD
DIELECTRIC (X2)	TEFLON (PTFE)
CAP	BRASS
CAP PLATING	GOLD

50 Ohm IMPEDANCE  
500V PEAK VOLTAGE RATING  
TEMPERATURE RANGE: -55°C TO +155°C  
INTERFACE DIMENSIONS SIMILAR TO MIL-C-39012

MILLIMETER WAVE TECHNOLOGIES  
6501 W. FRYE ROAD, #23  
CHANDLER, AZ 85226

MCX R/A MALE SOLDER CABLE END  
for R405

Designed by  
N. JAIN

Checked by  
W. CANON

Approved by  
A. LEE

File name  
MWX-8001G-086

TITLE  
MWX-8001G-086

TOLERANCES  
DIMENSIONS ARE IN INCHES UNLESS  
OTHERWISE SPECIFIED  
DECIMALS .02 ANGULAR ± .06  
.XX ± .005  
.XXX ± .005  
DO NOT SCALE THIS DRAWING

ALL DIMENSIONS ON THIS DRAWING ARE FOR REFERENCE  
PURPOSES ONLY AND ARE SUBJECT TO CHANGE.

REV.  
2

DATE  
061005

Scale  
NONE

Sheet  
1 of 1