

RevNo	Revision Notes	Date	Checked
1	Base Height Increased by .015"	022503	G.C.

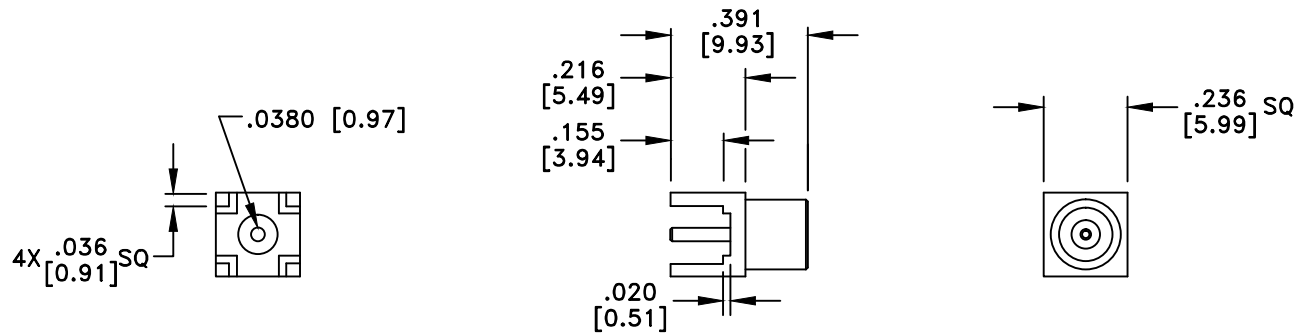

### MATERIALS

BODY	BRASS
BODY PLATING	GOLD
CONTACT	BERYLLIUM COPPER
CONTACT PLATING	30u" GOLD
DIELECTRIC	TEFLON (PTFE)

50 Ohm IMPEDANCE  
500V PEAK VOLTAGE RATING  
TEMPERATURE RANGE: -55°C TO +155°C  
INTERFACE DIMENSIONS SIMILAR TO MIL-C-39012

MILLIMETER WAVE TECHNOLOGIES  
1881 E. MINTON DR.  
TEMPE, AZ 85282

MCX FEMALE VERTICAL  
PCB MOUNT  
.155" LEGS

Designed by G.COLEMERE	Checked by W. CANON	Approved by A. LEE	File name MWX-7700G-155	TITLE MWX-7700G-155
<b>TOLERANCES</b> <small>DIMENSIONS IN INCHES UNLESS OTHERWISE SPECIFIED</small> DECIMALS .XX ± .02 .XXX ± .005		ALL DIMENSIONS ON THIS DRAWING ARE FOR REFERENCE PURPOSES ONLY AND ARE SUBJECT TO CHANGE.		REV. 1 DATE 022503
				Scale NONE Sheet 1 of 1