

RevNo	Revision Notes	Date	Checked
1	Pin Diameter Changed to .020"	121001	A.L.
2	RoHS Compliant	042205	PC

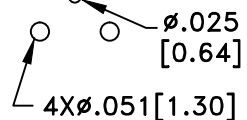

RECOMMENDED  
HOLE PATTERN

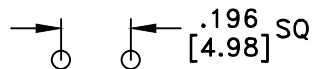
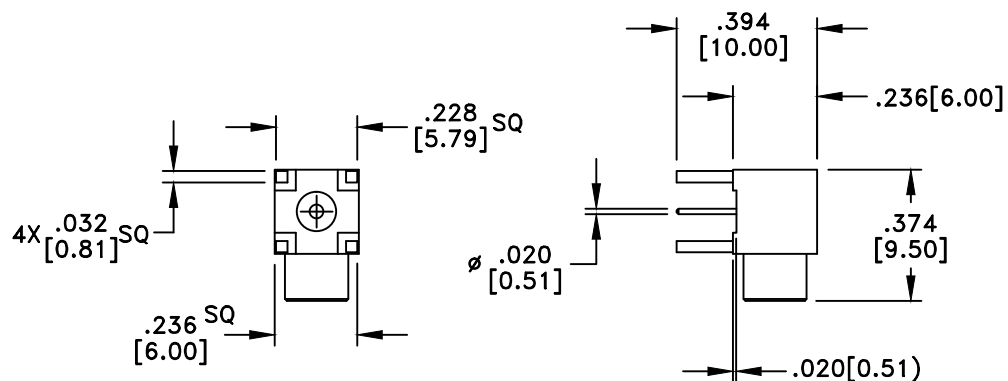

RoHS Compliant

### MATERIALS

BODY	BRASS
BODY PLATING	GOLD
CONTACT	BERYLLIUM COPPER
CONTACT PLATING	30u" GOLD
DIELECTRIC	TEFLON (PTFE)

50 Ohm IMPEDANCE  
500V PEAK VOLTAGE RATING  
TEMPERATURE RANGE: -55°C TO +155°C  
INTERFACE DIMENSIONS SIMILAR TO MIL-C-39012

MILLIMETER WAVE TECHNOLOGIES 6501 W. FRYE ROAD, #23 CHANDLER, AZ 85226			MCX FEMALE RIGHT ANGLE PCB MOUNT 4 LEGS 50 OHMS			
Designed by N. JAIN	Checked by S. NEUGESS	Approved by A. LEE	File name MWX-3300-G	TITLE MWX-3300-G		
TOLERANCES <small>DIMENSIONS IN INCHES UNLESS OTHERWISE SPECIFIED</small> DECIMALS            ANGULAR .XX ± .02            ± .06 .XXX ± .005			ALL DIMENSIONS ON THIS DRAWING ARE FOR REFERENCE PURPOSES ONLY AND ARE SUBJECT TO CHANGE.		REV. 2 DATE 020201	Scale NONE Sheet 1 of 1