

RevNo	Revision Notes	Date	Checked
1	Pin Diameter Changed to .020"	121001	A.L.
2	RoHS Compliant	042205	PC

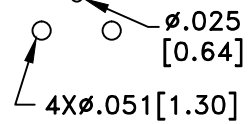

RECOMMENDED
HOLE PATTERN

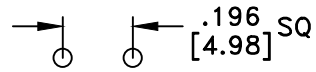
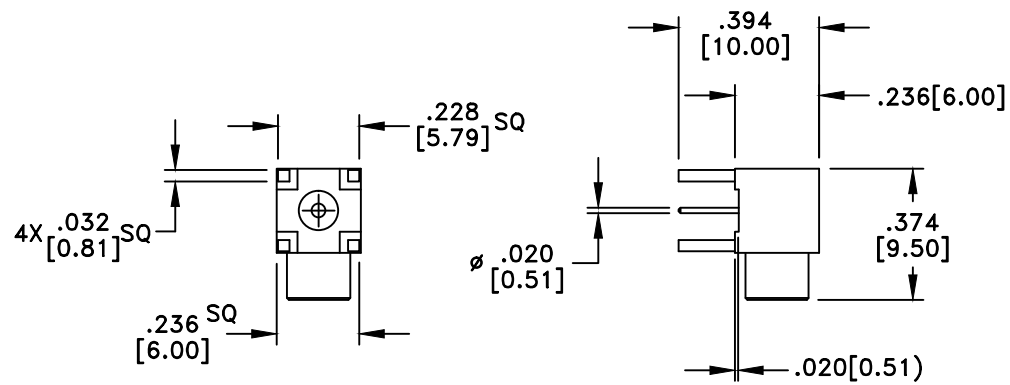

RoHS Compliant

MATERIALS

BODY	BRASS
BODY PLATING	GOLD
CONTACT	BERYLLIUM COPPER
CONTACT PLATING	30u" GOLD
DIELECTRIC	TEFLON (PTFE)

75 Ohm IMPEDANCE
500V PEAK VOLTAGE RATING
TEMPERATURE RANGE: -55°C TO +155°C
INTERFACE DIMENSIONS SIMILAR TO MIL-C-39012

MILLIMETER WAVE TECHNOLOGIES 6501 W. FRYE ROAD, #23 CHANDLER, AZ 85226			MCX FEMALE RIGHT ANGLE PCB MOUNT 4 LEGS 75 OHMS		
Designed by N. JAIN	Checked by S. NEUGESS	Approved by A. LEE	File name MWX-3300-G-75	TITLE MWX-3300-G-75	
TOLERANCES DIMENSIONS IN INCHES UNLESS OTHERWISE SPECIFIED DECIMALS .XX ± .02 .XXX ± .005 ANGULAR ± .06			ALL DIMENSIONS ON THIS DRAWING ARE FOR REFERENCE PURPOSES ONLY AND ARE SUBJECT TO CHANGE.		REV. 2 DATE 020201 Scale NONE Sheet 1 of 1