

| RevNo | Revision Notes                              | Date   | Checked |
|-------|---|--------|---------|
| 1     | Contact material changed to Phosphor Bronze | 011703 | P.C.    |

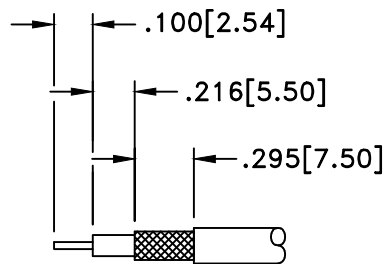

STRIP LENGTHS  
RG58

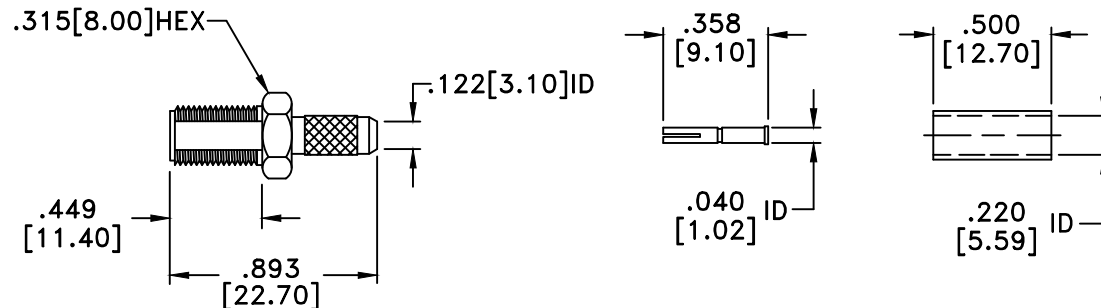

RoHS Compliant

### MATERIALS

|                 |                 |
|-----------------|-----------------|
| BODY            | BRASS           |
| BODY PLATING    | NICKEL          |
| CONTACT         | PHOSPHOR BRONZE |
| CONTACT PLATING | GOLD            |
| DIELECTRIC      | TEFLON (PTFE)   |

50 Ohm IMPEDANCE  
500V PEAK VOLTAGE RATING  
TEMPERATURE RANGE: -55°C TO +155°C  
INTERFACE DIMENSIONS SIMILAR TO MIL-C-39012

MILLIMETER WAVE TECHNOLOGIES  
6501 W. FRYE ROAD, #23  
CHANDLER, AZ 85226

SMA FEMALE CRIMP CABLE END  
for RG58

|  |                          |  |                          |                             |                                  |
|--|--------------------------|--|--------------------------|-----------------------------|----------------------------------|
| Designed by<br>P. CHEN   | Checked by<br>S. NEUGESS | Approved by<br>A. LEE  | File name<br>MWA-6099-58 | TITLE<br>MWA-6099-58        |                                  |
| TOLERANCES<br><small>DIMENSIONS IN INCHES UNLESS OTHERWISE SPECIFIED</small><br>DECIMALS            ANGULAR<br>.XX ± .02            ± .06<br>.XXX ± .005 |                          | ALL DIMENSIONS ON THIS DRAWING ARE FOR REFERENCE<br>PURPOSES ONLY AND ARE SUBJECT TO CHANGE. |                          | REV.<br>1<br>DATE<br>010903 | Scale<br>NONE<br>Sheet<br>1 of 1 |