

RevNo	Revision Notes	Date	Checked
1	RoHS Compliant	111005	PC

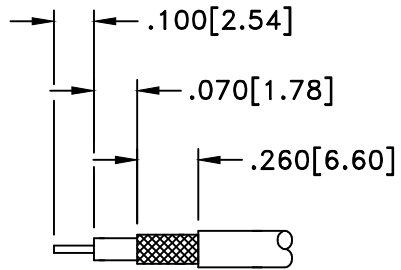

STRIP LENGTHS
M17/113-RG316

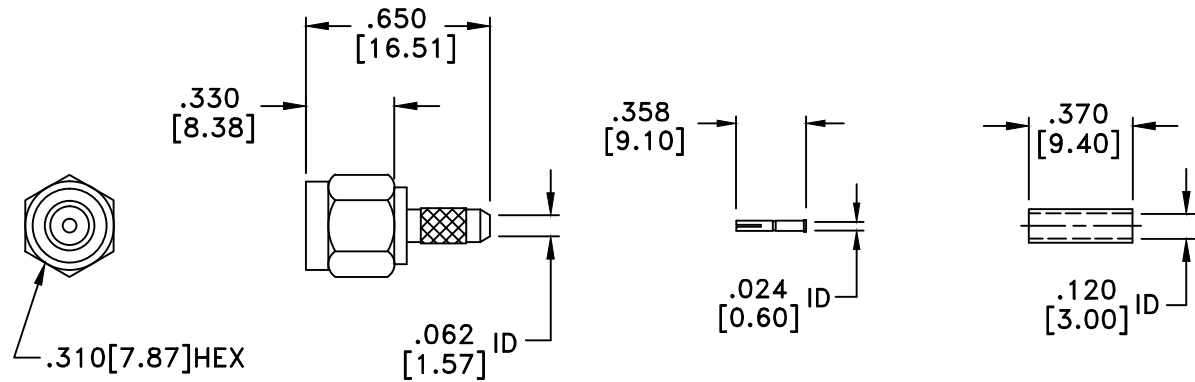

RoHS Compliant

MATERIALS

BODY	BRASS
BODY PLATING	NICKEL
CONTACT	BERYLLIUM COPPER
CONTACT PLATING	GOLD
DIELECTRIC	TEFLON (PTFE)
FERRULE	BRASS
FERRULE PLATING	NICKEL

50 Ohm IMPEDANCE
500V PEAK VOLTAGE RATING
TEMPERATURE RANGE: -55°C TO +155°C
INTERFACE DIMENSIONS SIMILAR TO MIL-C-39012

MILLIMETER WAVE TECHNOLOGIES 6501 W. FRYE ROAD, #23 CHANDLER, AZ 85226			SMA REVERSE POLARITY PLUG CRIMP CABLE END for RG316			
Designed by N. JAIN	Checked by W. CANON	Approved by A. LEE	File name MWA-6001-RP-316	TITLE MWA-6001-RP-316		
TOLERANCES <small>DIMENSIONS IN INCHES UNLESS OTHERWISE SPECIFIED</small> DECIMALS ANGULAR .XX ± .02 ± .06 .XXX ± .005			ALL DIMENSIONS ON THIS DRAWING ARE FOR REFERENCE PURPOSES ONLY AND ARE SUBJECT TO CHANGE.		REV. 1 DATE 062901	Scale NONE Sheet 1 of 1