

RevNo	Revision Notes	Date	Checked
1	Initial Release	061005	GC

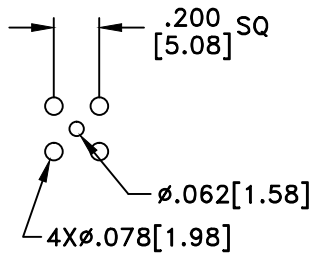

RECOMMENDED  
HOLE PATTERN

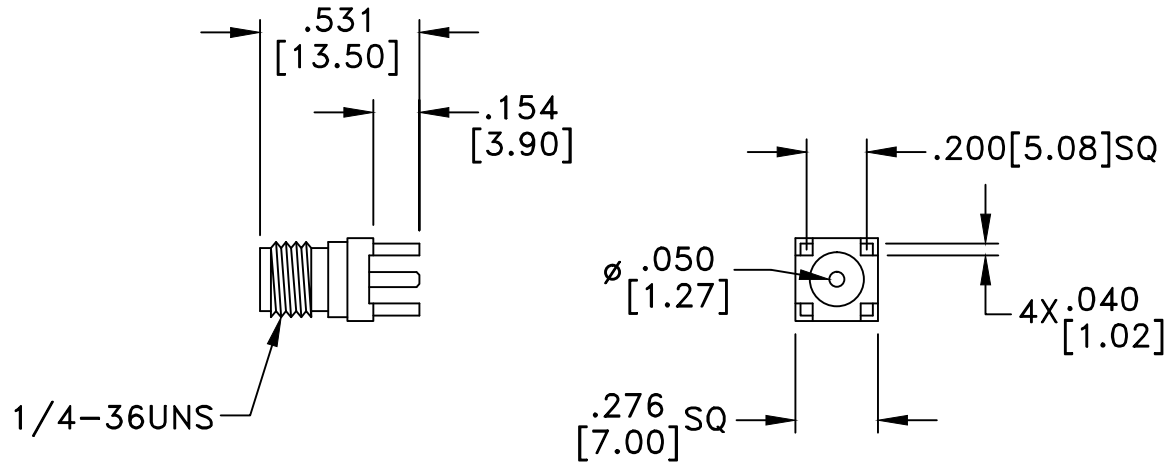

RoHS COMPLIANT

### MATERIALS

BODY	BRASS
BODY PLATING	GOLD
CONTACT	BERYLLIUM COPPER
CONTACT PLATING	GOLD
DIELECTRIC	TEFLON (PTFE)

50 Ohm IMPEDANCE  
500V PEAK VOLTAGE RATING  
TEMPERATURE RANGE: -55°C TO +155°C  
INTERFACE DIMENSIONS SIMILAR TO MIL-C-39012

MILLIMETER WAVE TECHNOLOGIES 6501 W. FRYE ROAD, #23 CHANDLER, AZ 85226		SMA FEMALE VERTICAL PCB MOUNT w/4 LEGS	
Designed by P. CHEN	Checked by S. NEUGESS	Approved by A. LEE	File name MWA-4400-G
TOLERANCES DIMENSIONS IN INCHES UNLESS OTHERWISE SPECIFIED		TITLE MWA-4400-G	
DECIMALS .XX ± .02 .XXX ± .005	ANGULAR ± .06	ALL DIMENSIONS ON THIS DRAWING ARE FOR REFERENCE PURPOSES ONLY AND ARE SUBJECT TO CHANGE.	
		REV. 1	Scale NONE
		DATE 061005	Sheet 1 of 1