

RevNo	Revision Notes	Date	Checked
1	Shoulder thickness changed to .099"	030405	G.C.
2	Center pin to tip of shoulder dimension corrected to read as .315"	031005	G.C.
3	RoHS Compliant	081005	G.C.

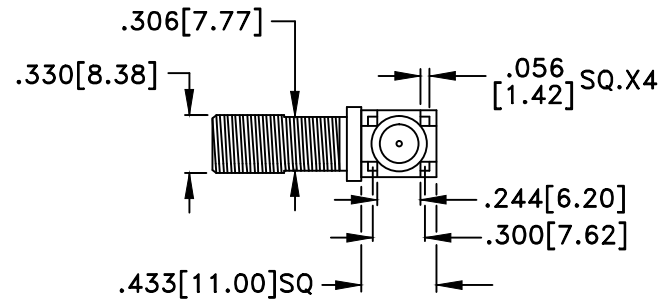
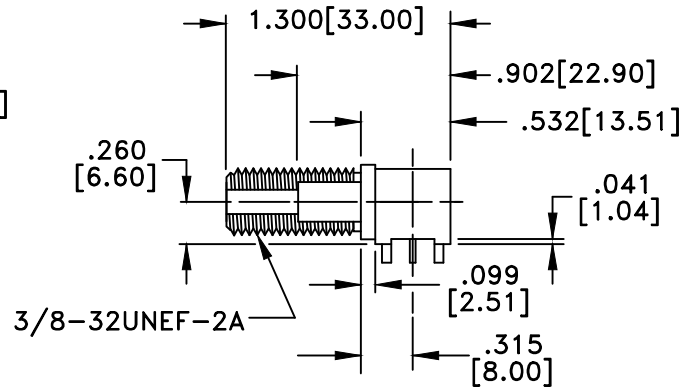
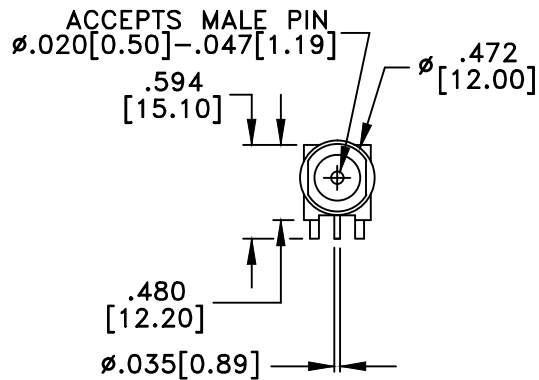
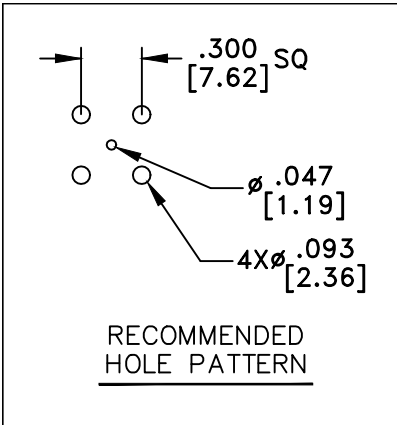

RoHS Compliant

MATERIALS	
BODY	BRASS
BODY PLATING	BRIGHT ACID TIN
CONTACT	BRASS/BeCu
CONTACT PLATING	GOLD
DIELECTRIC	TEFLON (PTFE)
75 Ohm IMPEDANCE	
500V PEAK VOLTAGE RATING	
TEMPERATURE RANGE: -55°C TO +155°C	
INTERFACE DIMENSIONS SIMILAR TO MIL-C-39012	

MILLIMETER WAVE TECHNOLOGIES 6501 W. FRYE ROAD, #23 CHANDLER, AZ 85226			F FEMALE RIGHT ANGLE PCB MOUNT w/4 LEGS FLAT NOSE, H/P 75 OHMS			
Designed by P. CHEN	Checked by S. NEUGESS	Approved by A. LEE	File name MW-840-ASC-75	TITLE MW-840-ASC-75		
TOLERANCES DIMENSIONS IN INCHES UNLESS OTHERWISE SPECIFIED DECIMALS ANGULAR .XX ± .02 ± .06 .XXX ± .005			ALL DIMENSIONS ON THIS DRAWING ARE FOR REFERENCE PURPOSES ONLY AND ARE SUBJECT TO CHANGE.		REV. 3 DATE 121002	Scale NONE Sheet 1 of 1