

RevNo	Revision Notes	Date	Checked
1	RoHS Compliant	081005	GC

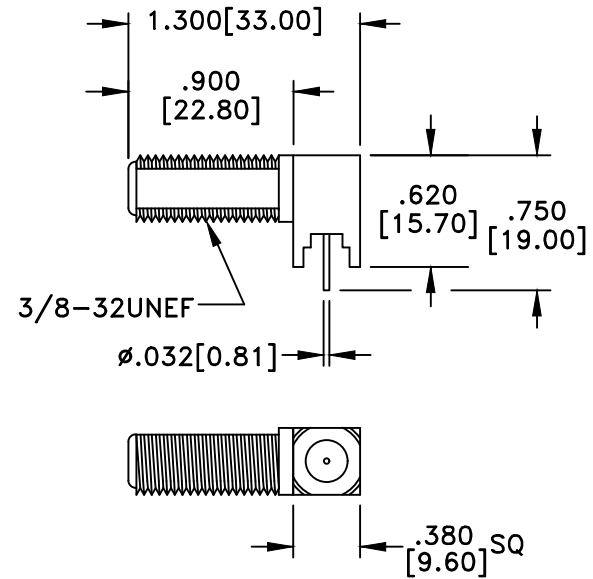
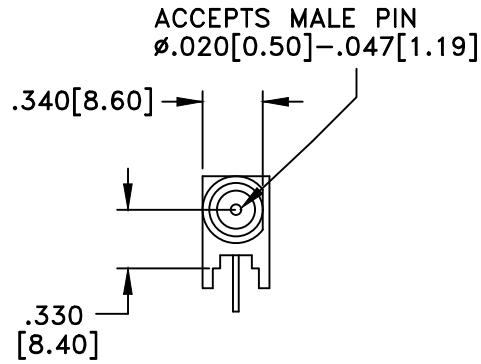
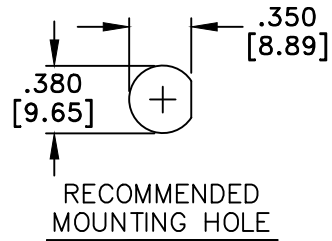
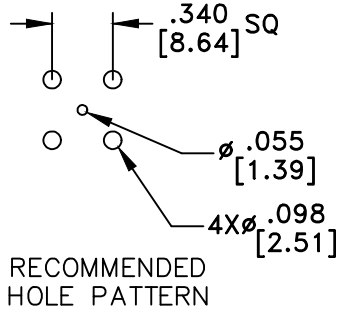

RoHS Compliant

MATERIAL

BODY	BRASS
BODY PLATING	NICKEL
CONTACT	BRASS/BeCu
CONTACT PLATING	GOLD
DIELECTRIC	TEFLON (PTFE)

75 Ohm IMPEDANCE
500V PEAK VOLTAGE RATING
TEMPERATURE RANGE: -55°C TO +155°C
INTERFACE DIMENSIONS SIMILAR TO MIL-C-39012

MILLIMETER WAVE TECHNOLOGIES
6501 W. FRYE ROAD, #23
CHANDLER, AZ 85226

F FEMALE RIGHT ANGLE
PCB MOUNT w/4 LEGS
HIGH PERFORMANCE

Designed by N. JAIN	Checked by W. CANON	Approved by A. LEE	File name MW-840-75	TITLE MW-840-75
TOLERANCES DIMENSIONS ARE IN INCHES UNLESS OTHERWISE SPECIFIED DECIMALS ANGULAR XX ± .02 ± .06 XXX ± .005 ± .06 DO NOT SCALE THIS DRAWING			ALL DIMENSIONS ON THIS DRAWING ARE FOR REFERENCE PURPOSES ONLY AND ARE SUBJECT TO CHANGE.	
			REV. 1	Scale NONE
			DATE 030101	Sheet 1 of 1