

RevNo	Revision Notes	Date	Checked
1	RoHS Compliant	04/07/08	GC
2	Body length corrected to .770"	04/07/08	GC

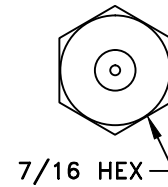
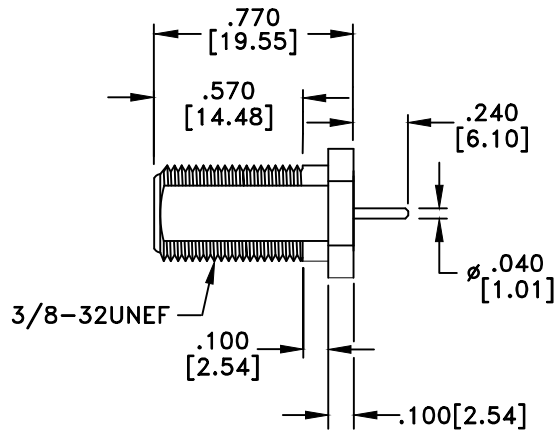
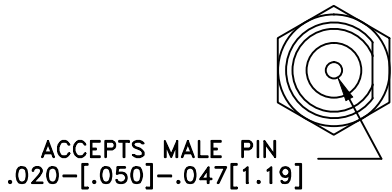

NOTES: INCLUDES HEX NUT & INTERNAL TOOTH LOCKWASHER

RoHS Compliant

MATERIALS	
BODY	BRASS
BODY PLATING	NICKEL
CONTACT	BRASS/BeCu
CONTACT PLATING	GOLD
DIELECTRIC	TEFLON (PTFE)
75 Ohm IMPEDANCE 500V PEAK VOLTAGE RATING TEMPERATURE RANGE: -55°C TO +155°C INTERFACE DIMENSIONS SIMILAR TO MIL-C-39012	

MILLIMETER WAVE TECHNOLOGIES 6501 W. FRYE ROAD, #23 CHANDLER, AZ 85226			HIGH PERFORMANCE F FEMALE BULKHEAD SOLDER CONTACT		
Designed by N. JAIN	Checked by W. CANON	Approved by A. LEE	File name MW-817-D-75	TITLE MW-817-D-75	
TOLERANCES DIMENSIONS IN INCHES UNLESS OTHERWISE SPECIFIED DECIMALS .XX ± .02 .XXX ± .005		ALL DIMENSIONS ON THIS DRAWING ARE FOR REFERENCE PURPOSES ONLY AND ARE SUBJECT TO CHANGE.			REV. 2 DATE 072501
			Scale NONE Sheet 1 of 1		