

RevNo	Revision Notes	Date	Checked
1	Initial Release	050211	GC

ACCEPTS MALE PIN
CABLE CENTER CONDUCTOR
Ø.020[.50]–.047[1.19]

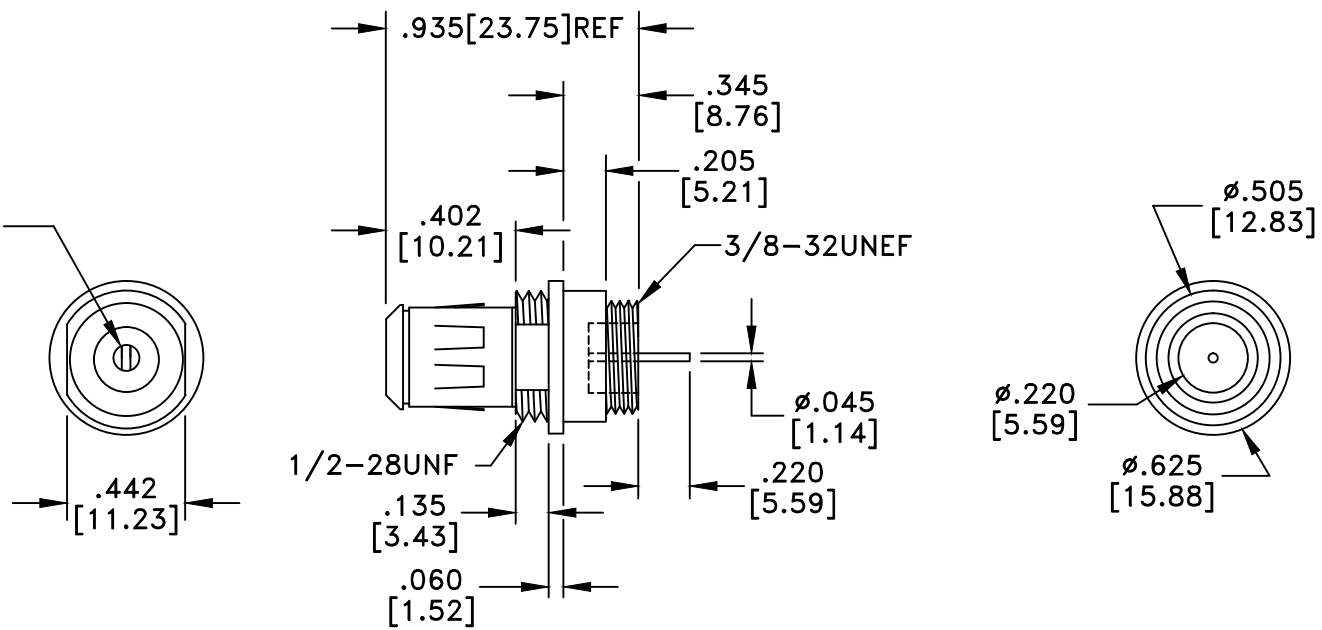

RoHS Compliant

DIELECTRIC RECESSED APPROX. .265[6.73] FROM EDGE OF CONNECTOR

MATERIALS	
BODY	BRASS
BODY PLATING	NICKEL
CONTACT	STEEL
CONTACT PLATING	GOLD
DIELECTRIC	TEFLON
75 Ohm IMPEDANCE	
500V PEAK VOLTAGE RATING	
TEMPERATURE RANGE: -55°C TO +155°C	
INTERFACE DIMENSIONS SIMILAR TO MIL-C-39012	

MILLIMETER WAVE TECHNOLOGIES 6501 W. FRYE ROAD, #23 CHANDLER, AZ 85226			G FEMALE CHASSIS MOUNT			
Designed by N. JAIN	Checked by W. CANON	Approved by A. LEE	File name MW-807-DD	TITLE MW-807-DD		
TOLERANCES DIMENSIONS IN INCHES UNLESS OTHERWISE SPECIFIED DECIMALS ANGULAR .XX ± .02 ± .06 .XXX ± .005			ALL DIMENSIONS ON THIS DRAWING ARE FOR REFERENCE PURPOSES ONLY AND ARE SUBJECT TO CHANGE.		REV. 1 DATE 050211	Scale NONE Sheet 1 of 1